

Before visiting a store to get a quote for your hard surface countertop, please carefully measure your countertop. Refer to the example below to adequately measure your countertop, edge and backsplash. Make sure to also bring a sketch of your kitchen with dimensions written on it.

HOW CALCULATE THE SQUARE FOOTAGE

Step 1: Divide the surface into rectangles and attribute each piece a letter (A, B...).

Step 2: For each piece, multiply the width by the depth to obtain sq. in.

Step 3: Add each surface's sq. in. and divide by 144 to obtain sq. ft.

STEPS	
1: 96" x 25.5"	2,448"
2: 82.5" x 25.5"	2,103.75"
3: 2,448" + 2,103.75" = 4,551.75" ÷ 144	31.6 Sq^{ft}

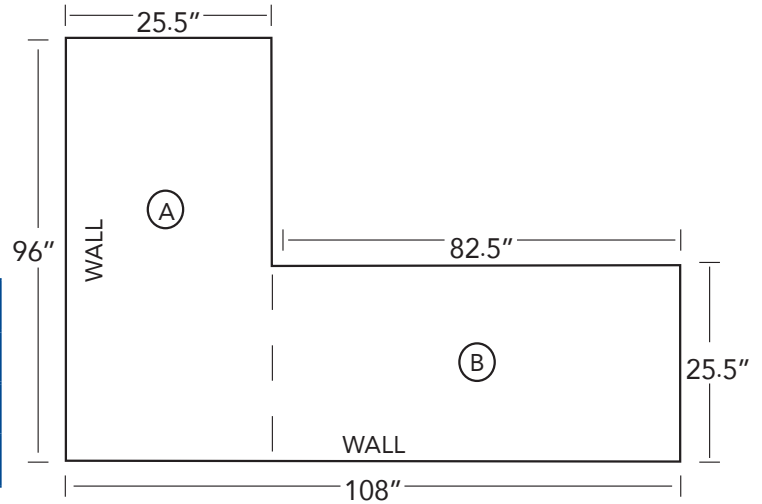

HOW TO CALCULATE THE EDGE

Step 4: Determine and add each side that will require an edge profile and divide by 12 to obtain the total linear feet.

Étape 5: Identify the edges that will require polishing with a dot.

STEPS	
4: 25.5" + 82.5" + 70.5" + 25.5" = 204" ÷ 12	17 lin^{ft}

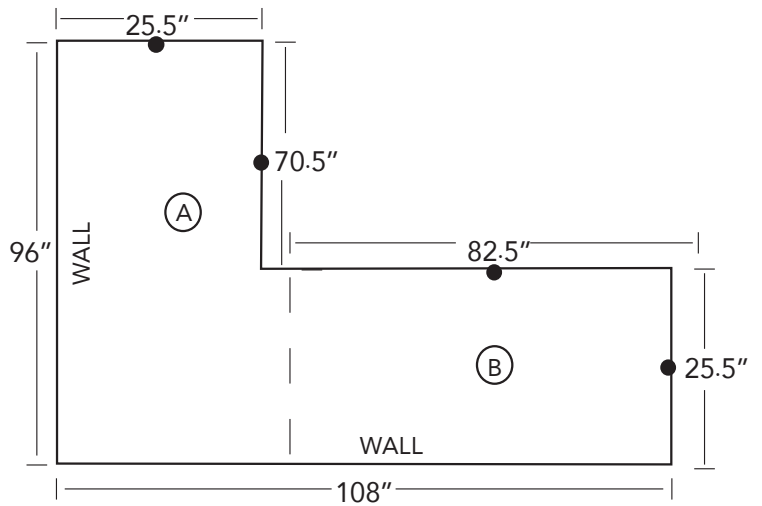

HOW TO CALCULATE A BACKSPLASH

Step 6: Determine and add each length that will have a backsplash and divide by 12 to determine lin. ft.

Step 7: Using a thicker line, identify areas where a backsplash will be installed.

STEPS	
6: 96" + 108" = 204" ÷ 12	17 lin^{ft}

